

T5 5" Touch On-Camera Monitor

- 1920x1080 Resolution
- TOUCH
- HDMI 2.0 4K 60Hz
- HDR 3D-LUT



Touch On-Camera Monitor with Full HD Resolution, excellent color space
Perfect gear on DSLR for taking photos & making movies.



4K 60Hz - HDMI 2.0

HDMI 2.0 supports 4096x2160 60p/50p/30p/25p and 3840x2160 60p/50p/30p/25p.

Some commercially DSLR(GH-5, R5...) have been upgraded to HDMI 4K 60Hz video output. It means this touch monitor is compatible with the best output video formats of DSLR on the market.

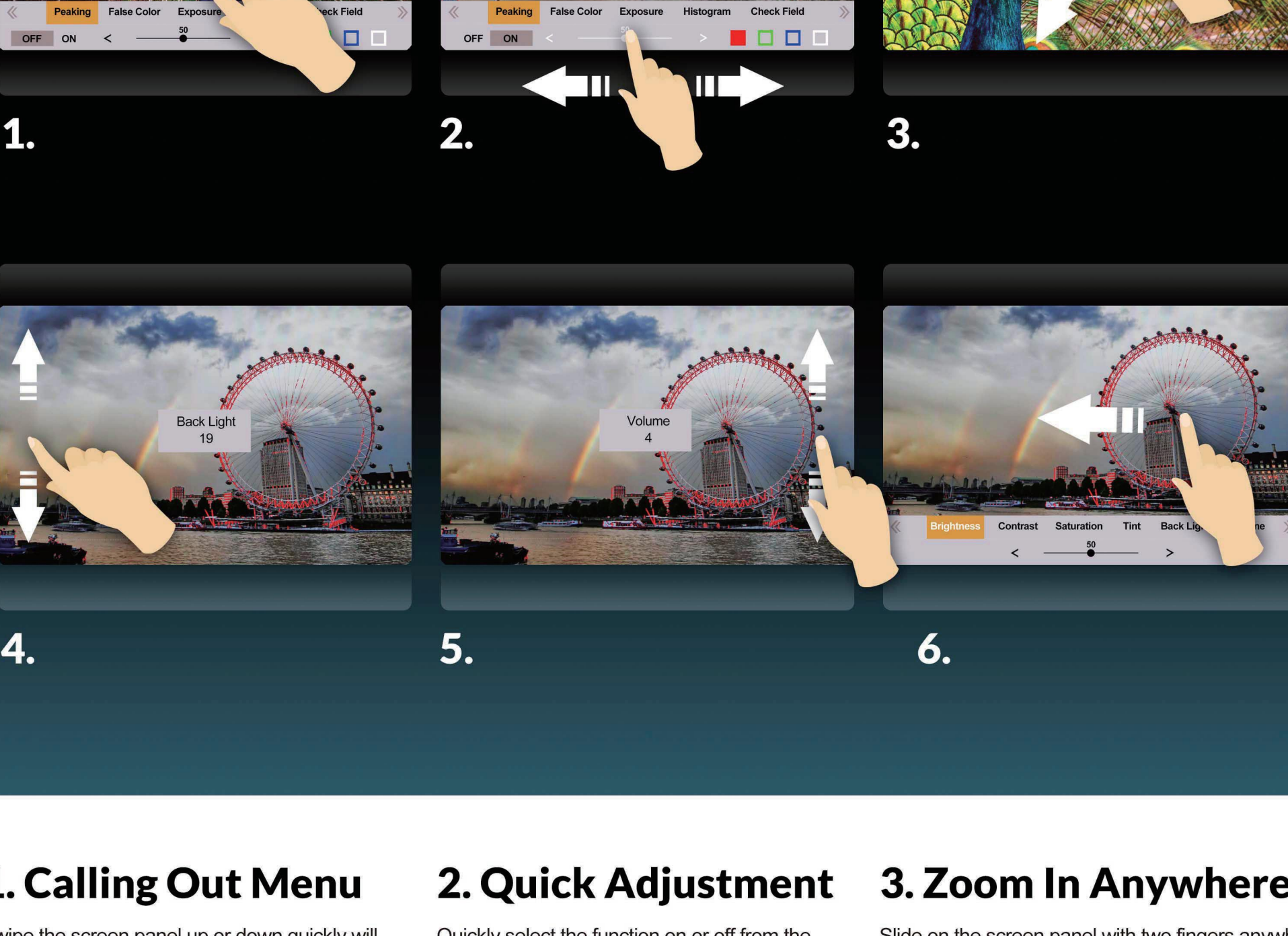

1. Calling Out Menu

Swipe the screen panel up or down quickly will summon the menu. Then repeat action to close the menu.

2. Quick Adjustment

Quickly select the function on or off from the menu, or slide freely to adjust the value.

3. Zoom In Anywhere

Slide on the screen panel with two fingers anywhere to enlarge the image, and easy drag it to any position.

4. Back Light Control

Swipe up and down on the left side of the screen to adjust the backlight.

5. Volume Control

Swipe up and down on the right side of the screen to adjust the volume.

6. Display Menu

Slide the screen left or right to quickly adjust the display parameters.

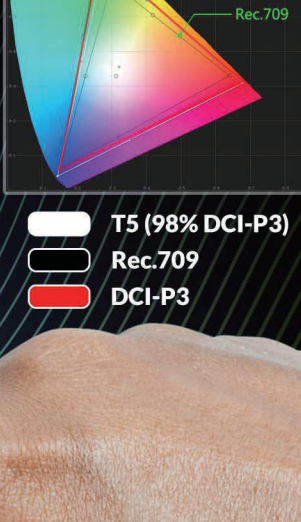
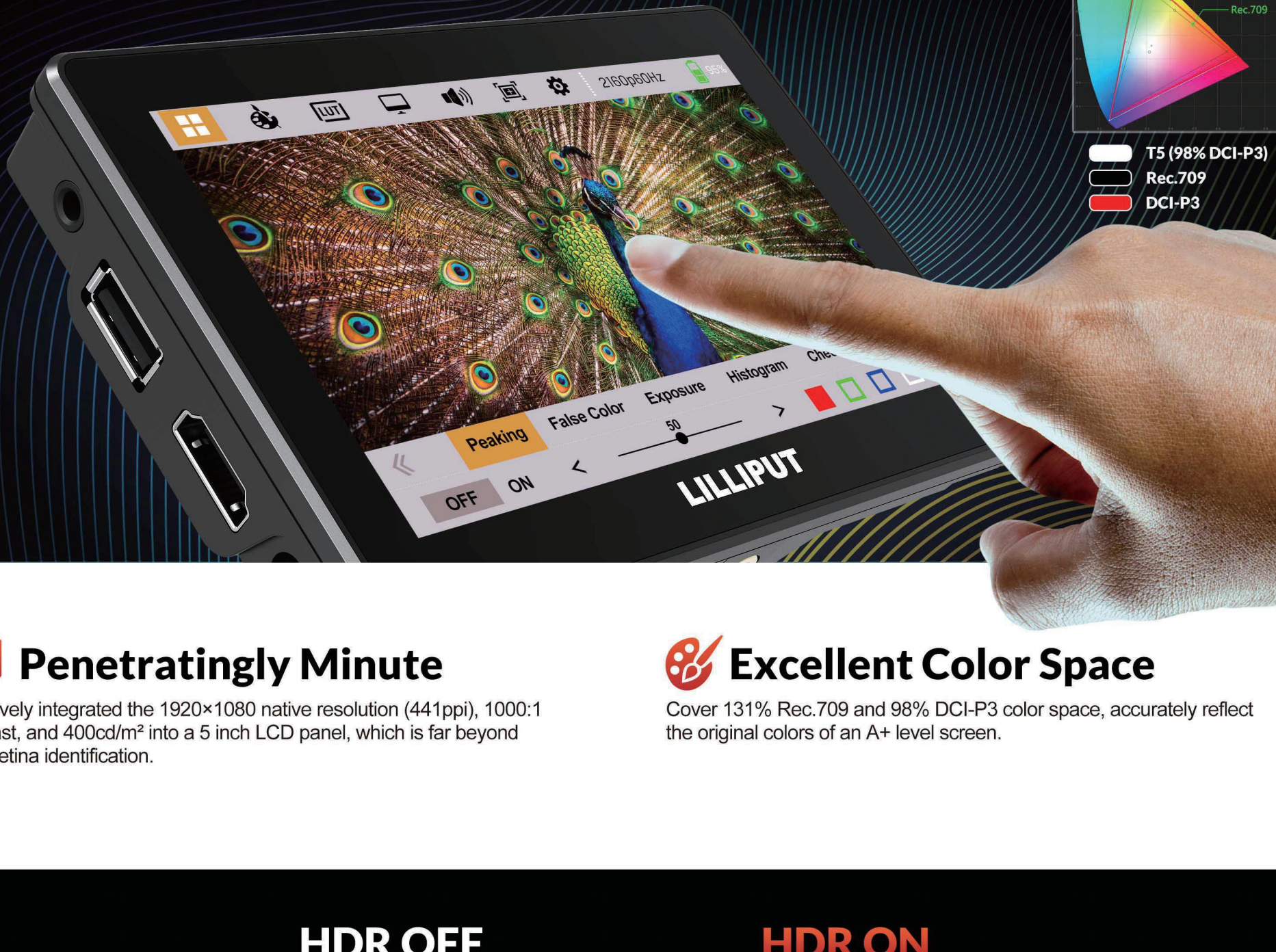

Penetratingly Minute

Creatively integrated the 1920x1080 native resolution (441ppi), 1000:1 contrast, and 400cd/m² into a 5 inch LCD panel, which is far beyond from retina identification.

Excellent Color Space

Cover 131% Rec.709 and 98% DCI-P3 color space, accurately reflect the original colors of an A+ level screen.

HDR OFF vs HDR ON

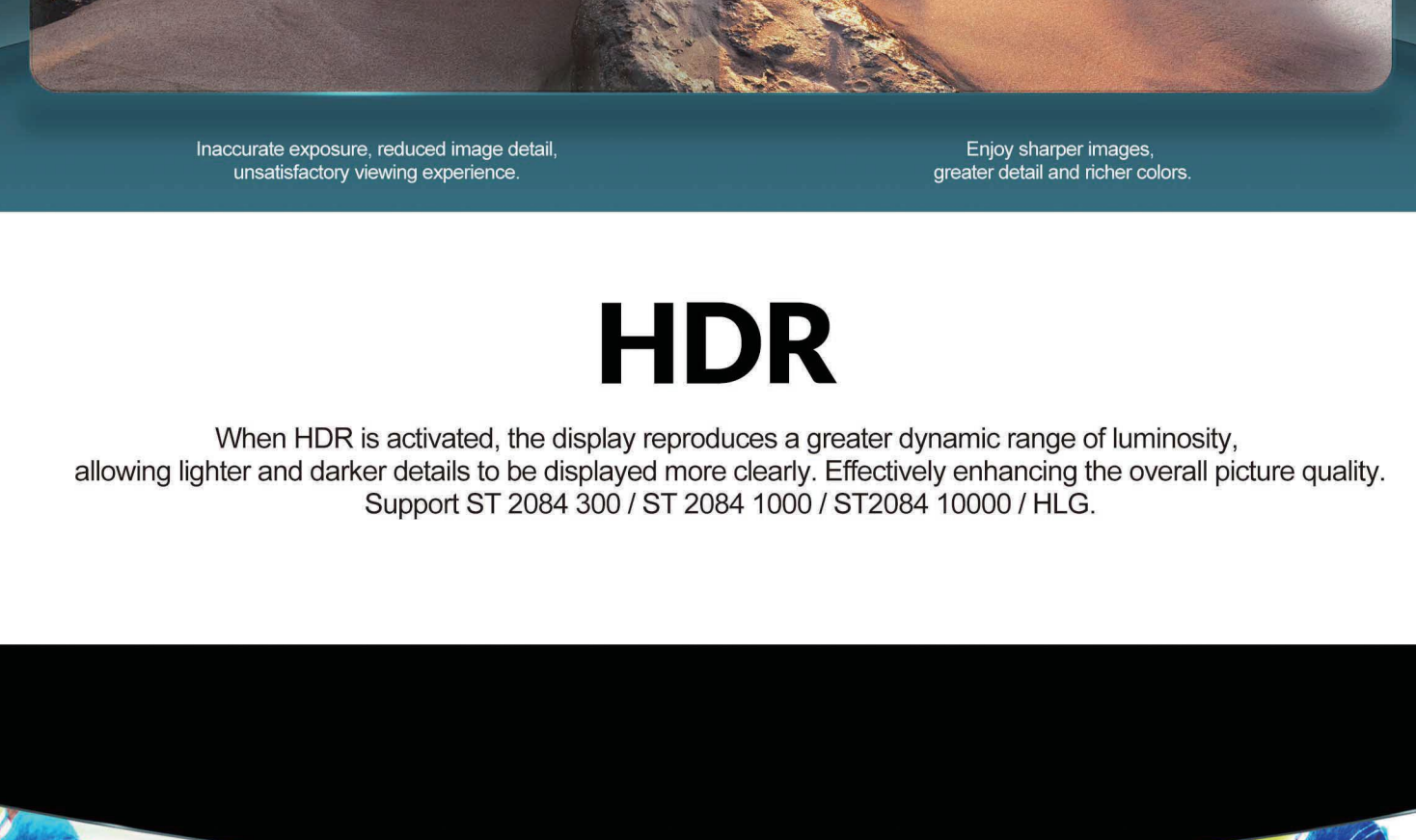

HDR

When HDR is activated, the display reproduces a greater dynamic range of luminosity, allowing lighter and darker details to be displayed more clearly. Effectively enhancing the overall picture quality. Support ST 2084 300 / ST 2084 1000 / ST2084 10000 / HLG.



3D LUT

3D-LUT is a table for quickly looking up and output specific color data. By loading different 3D-LUT tables, it can quickly recombine color tone to form different color styles. Built-in 3D-LUT, featuring 8 default logs and 6 user logs.

3D LUT LOAD

Supports loading the .cube file via USB flash disk.

LEVEL METERS

The left side of the on screen meters displays level meters showing audio levels for channels 1 and 2 of the input source.

HISTOGRAM

A display that indicates how many of the pixels in a photo are at that given level of brightness.

FALSE COLOR

An image that depicts an object in colors that differ from those a photograph (a true-color image) would show. Support ARRI, RED false color.

MARKERS

Provide center marker and safety markers.

PEAKING FOCUS

It highlights the areas that are in focus so you are able to quickly focus the camera and not miss crucial shots.

EXPOSURE

Areas of the image over a certain threshold are filled with a striped pattern to dramatically highlight areas where too much light is falling on the image sensor

CHECK FIELD

When enabled, hue and saturation can be adjusted quickly and accurately especially in broadcast area display.

ASPECT RATIO

Provides a wide variety of aspect ratio to match different camera anamorphic lenses.

ZOOM

Zoom in and out by adjusting the horizontal and vertical axis of the screen position.

Camera Auxiliary Functions

Provides plenty of auxiliary functions for taking photos and making movies, such as peaking, false color and audio level meter.

- 3D LUT
- HDR
- Peaking
- Level meter
- LUT support
- False color
- Histogram
- HV Delay
- Exposure
- Check field
- Image flip
- Pe-to-iso
- Marker
- Freeze



Versatile Battery Structure

A dual battery mounting plate on the back is compatible with both Canon LP-E6 and Sony F-series batteries, and the DC 8V power output is also useful for unlimited purposes.



SPECIFICATIONS

DISPLAY	Panel: 5" IPS Touch Screen: Capacitive Physical Resolution: 1920x1080 Aspect Ratio: 16:9 Brightness: 400cd/m ² Contrast: 1000:1 Viewing Angle: 170°/ 170°(H/V) HDR: ST 2084 300/1000/10000 / HLG
VIDEO INPUT SUPPORTED FORMATS AUDIO IN/OUT (48kHz PCM Audio)	LUT support: Sony Slog2 / Slog3 or User... HDMI: 1xHDMI2.0 HDMI: 2160p 24/25/30/50/60, 1080p 24/25/30/50/60, 1080i 50/60, 720p 50/60... Ear Jack: 3.5mm - 2ch 48kHz 24-bit
POWER	Input Voltage: DC 7-24V Power Consumption: ≤5W / ≤17W (DC 8V power output in operation) Compatible Batteries: Canon LP-E6 & Sony F-series Power Output: DC 8V
ENVIRONMENT	Operating Temperature: 0°C-50°C Storage Temperature: -10°C-60°C
OTHER	Dimension(LWD): 132x86x18.5mm Weight: 200g

ACCESSORIES

