

Canon

HJ17ex6.2B

PREMIUM STANDARD HDTV LENS: WIDER & CLOSER, BRINGS ADDITIONAL MOBILITY TO HD VIDEO PRODUCTION



INNOVATION

In TV Optics Since 1958

Toward 100 years anniversary

HDXS

HJ17ex6.2B

HDXS



As HD continues to become the worldwide standard for broadcast TV production, there is an increasing need for versatility in HDTV lenses that enable more efficient production operations without sacrificing high picture quality. In particular, there is strong demand for lenses that combine superior wide-angle performance with sufficient telephoto range to boost the mobility of camera crews and make operations more efficient. To fulfill the needs of users such as these, Canon has researched and developed the HJ17ex6.2B, embodying the uncompromising high-dimensional quality for which our products are known. The HJ17ex6.2B is fully equipped with the latest state-of-the-art Canon optical technologies, and serves as a highly innovative premium standard HDTV lens.

MAIN FEATURES

■ **The HJ17ex6.2B represents a further advancement of the HDxs Series, already the premier series of HDTV lenses.**

Offering optimum mobility, the HJ17ex6.2B premium standard HDTV lens is a new addition to the HDxs Series, Canon's premier HDTV lens lineup, with lenses covering a full range from Super Telephoto (1,120mm) to Super Wide (4.3mm). Professional users are now more able to select the appropriate lens for their expressive needs, and produce video with the high quality for which HDxs is renowned.

Canon HDxs lens series

Category	Zoom Ratio	Features	Focal Length (2/3 inch)																							
			4.3mm	6.2mm	7.5mm	8.5mm	10mm	14mm	28mm	60mm	106mm	120mm	128mm	130mm	158mm	168mm	212mm	260mm	316mm	400mm	500mm	560mm	800mm	1000mm	1120mm	
Telephoto	40x	ULTRA TELEPHOTO with Image Stabilizer																								
	40x	SUPER TELEPHOTO with Image Stabilizer																								
	18x	PORTABLE ULTRA TELEPHOTO																								
Multi-Purpose	22x	TELEPHOTO ENG/EFP LENS																								
Exclusive EFP	21x	SUPER QUALITY																								
Standard	17x	STANDARD ENG/EFP LENS																								
	17x	PREMIUM STANDARD (wider + closer)																								
Super Wide	14x	WIDEST ANGLE LENS (to date in TV industry)																								
Image Stabilized	15x	WIDER RANGE IS with VAP																								

■ Shoot closer, shoot wider. Improved mobility for camera crews in diverse situations.

• **When covering news stories on-site**, camera crews must work with a limited supply of equipment and react rapidly to various changes in subject distance and focal length.

The HJ17ex6.2B is capable of adapting flexibly to all manner of filming situations, whether shooting in close proximity to a subject or shooting close-ups of a subject from far away, without the need for changing lenses, thanks to its short M.O.D., extra-wide angle, 17x magnification, and built-in 2x extender.

- **For production of documentaries**, the HJ17ex6.2B enables vivid shooting even when ultra-close to the subject to make the scene come alive, or shooting in small rooms where distance from the subject cannot be attained,
- The HJ17ex6.2B is a single lens capable of flexible operation, enabling the **improved versatility** required by camera crews, **maximum cost- and performance-efficiency for productions**, and a wide range of **expressive possibilities**.

■ Superb optical performance. Wider focal length.

• With focal lengths ranging from wide-end to tele-end, and at subject distances ranging from infinite distance to extreme closeup (in which case optical performance generally suffers), the HJ17ex6.2B minimizes optical aberration across the entire screen and exhibits superb optical performance throughout the field.

- The HJ17ex6.2B provides the same magnification (17x) as our well-established HDTV production lens, the HJ17ex7.6B, while achieving a wider focal length of 6.2mm.
- M.O.D. has been shortened by approximately 30% (0.4m) compared to the HJ17ex7.6B.

Wider angle shot at the same object distance (0.6m) at wide end

	HJ17ex6.2B	HJ17ex7.6B
Focal length at Wide end	6.2mm	7.6mm
Angular Field of View at Wide end (16:9)	75.5°x47.1°	64.6°x39.1°

Closer distance to acquire same field of view

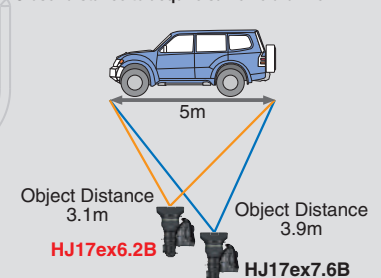

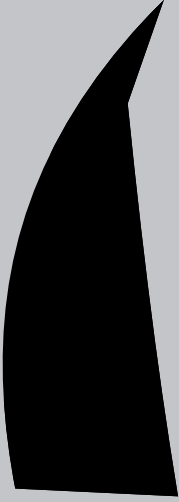

ACCESSORIES

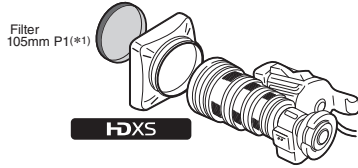

Filter
105mm P1(*1)

HDXS

Zoom/Focus
Manual Controllers

Focus Servo Controllers
(For IRSE Lenses)

Focus Servo Controllers
(For IASE Lenses)

Zoom
Servo Controllers

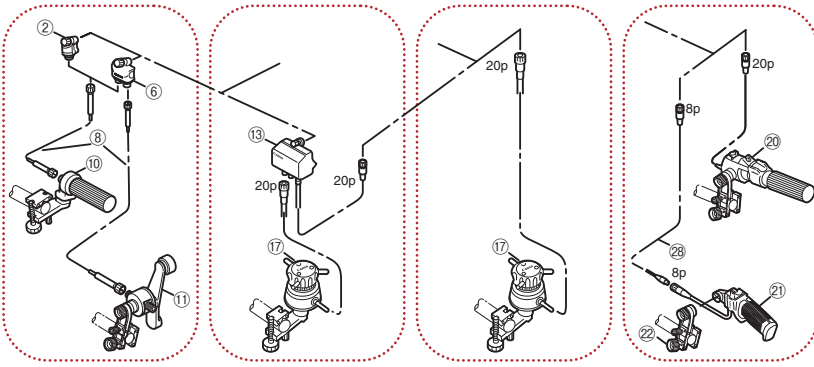

(*1) For the optical accessories, the 105mm diameter P1 filters are applicable. The filters are to be attached to the lens hood. (UV/Cross/Snow Cross/Sunny Cross/Polarized Light/Softon/ND8)
The optical converters and attachments are not applicable.

#	Unit	Description
②	FFM-100	Flex Focus Module
⑥	FFM-200	Flex Dual Module
⑧	FC-40	Flex Cable
⑩	FFC-200	Flex Focus Controller
⑪	FZC-100	Flex Zoom Controller
⑬	FPM-420D	Focus Positional Servo Module
⑰	FPD-400D	Focus Positional Demand
⑳	ZSD-300D	Zoom Servo Demand
㉑	ZSG-200M	Zoom Servo Grip
㉒	CR-10	Clamper
㉔	EC-80	Zoom Extension Cable (8P)

DIMENSIONS

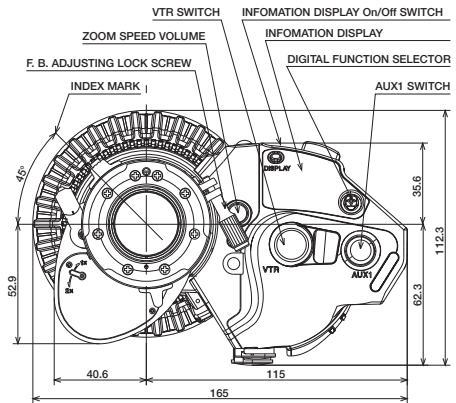
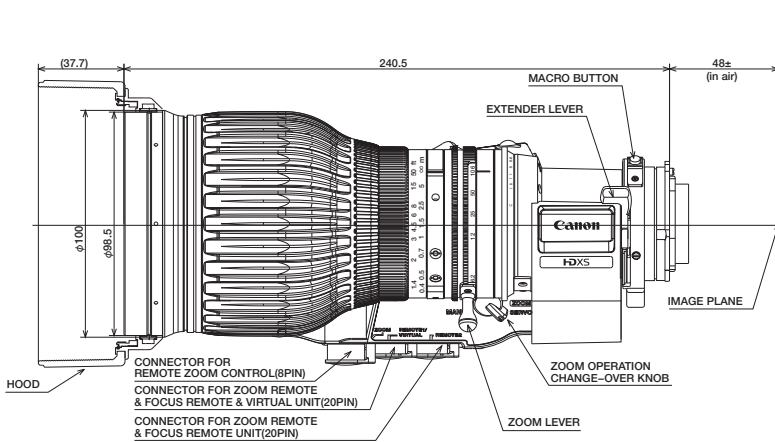

North & South America Canon U.S.A., Inc.

Imaging Technologies & Communications Group
Broadcast and Communications Sales & Marketing
Division (Headquarters)
65 Challenger Road, Ridgefield Park, NJ 07660
Tel:+1(201)807-3300/(800)321-4388
Fax:+1(201)807-3333
Email:bctv@cusa.canon.com
<http://www.canonbroadcast.com/>

Chicago

100 Park Blvd. Itasca, IL 60143
Tel:+1(630)250-6236 Fax:+1(630)250-0399

Atlanta

5625 Oakbrook Pkwy. Norcross, GA 30093
Tel:+1(770)849-7890 Fax:+1(770)849-7888

Los Angeles

15955 Alton Parkway Irvine, CA 92618
Tel:+1(949)753-4330 Fax:+1(949)753-4337

Dallas

3200 Regent Blvd. Irving, TX 75063
Tel:+1(972)409-8871 Fax:+1(972)409-8869

Latin America

Tel & Fax:+1(954)757-0980

Canada

Canon Canada, Inc.
Broadcast and Communications Div.
6390 Dixie Road
Mississauga, Ontario, L5T 1P7, Canada
Tel:+1(905)795-2012 Fax:+1(905)795-2140

Europe/Africa/Middle East Canon Europe Ltd

Broadcast Products Div.
3 The Square, Stockley Park
Uxbridge Middlesex
United Kingdom UB11 1ET
Tel:+44 (0)20 8588 8140
Fax:+44 (0)20 8588 8603
Email: tvprod@canon-europe.com
<http://www.canon-europe.com/tv-products/>

Australia Canon Australia Pty. Ltd.

Optical Products Division
1 Thomas Holt Drive, North Ryde, NSW 2113,
Australia
Tel:+61(0)2-9805-2000 Fax:+61(0)2-9805-2444

China

Canon (China) Co., Ltd.

Broadcast Equipment Products
15F Jinbao Building No.89 Jinbao Street
Dongcheng District, Beijing 100005, China
Tel:+86-10-8513-9999 Fax:+86-10-8513-9128
<http://www.canon.com.cn>

Asia/Japan

Canon Inc. (ICP GROUP 5)

30-2, Shimomaruko 3-chome, Ohta-ku, Tokyo
146-8501, Japan
Tel:+81(0)3-3757-7453 Fax:+81(0)3-3757-7086
<http://www.canon.com/bctv>

Distributed by

Specifications subject to change without notice.

Canon <http://www.canon.com/bctv>